

GENERAL SPECIFICATIONS

Shelving will be modular construction using the starter and adder design. Adder sections are designed to fasten to the uprights of both the starter section and other adders. Heights and depths will be as specified by catalog numbers and drawings. All sections will be standard width to assure shelf interchange between separate units.

CONSTRUCTION AND MATERIALS

All vertical uprights of shelving will be 1" thick veneer-core plywood "A" grade, plain sliced book-matched red oak. Intermediate panels will be 1" thick veneer core plain sliced red oak. All vertical uprights are banded with 1/4" T solid red oak. *Solid red oak uprights are available for an upcharge. Lumber core uprights are available upon request.*

All shelves will be kiln-dried solid red oak or maple, (no mixed wood) glued up in strips of no less than 3/4"W and no more than 2"W, and free from structural defects.

The starter section will have two vertical uprights and be 37" in total width. Shelf pin holes will be bored on 32mm centers on the inside of each end panel. These holes will be 15/16"D in diameter.

The adder section shall have one vertical upright and will be 36" in total width. Holes shall be bored on 32mm centers on both sides of the Adder panel with the same configuration as end panels.

Shelf pins will be 5/16"D and 1" in length. The smooth end fits inside the pin hole. The flange prevents the shelf pin from being dislodged and reduces shelf pin sagging. The underside of shelves shall be machined with slots to fit over the threaded end and flange portion of the shelf pins to prevent them from accidentally dislodging.



Top and bottom frames shall be 35" wide by the depth of shelving specified. Top frames shall be constructed of red oak veneer plywood with a cornice board that is 3/4" x 2-3/8" x 35" northern

grown solid red oak. The toe board shall be 3/4" T x 4"W x 35"L and attached to the bottom frame using a glued tongue and groove joint. Top and bottom frames shall be attached to the starter end panels with 5/16"-18 x 2-3/4" hex head machine bolts, screwed into internally-externally threaded inserts in the starter end panel. Adder panels shall be joined using 5/16"-18 x 6" hex head machine bolts, washers and 5/16"-18 nuts. Dovetail top and bottom frames are available for an additional charge.

Continuous tops for shelving units will be laminate faced, solid red oak edge banded, 3-ply construction with high density .050" thick high-pressure laminate and .020" thick backer sheet glued to opposite faces for a finished thickness of 1-1/4". These tops will be banded using edge details on page 169 which allows for edge detail coordination. Tops will be fabricated in the longest most practical lengths. All joints will have solid wood biscuits and tight-joint fastened. These continuous tops will be placed on top of and fastened to shelving top frames.

All shelving will be without backs unless otherwise specified. When specified, backs will be matching red oak veneer plywood panels 1/4" thick. Back panels of single-faced shelving will be good one side, and panels of double-faced shelving shall be good two sides. Backs will slide into a groove machined into the uprights.

Mobile Shelving: Double face shelving units up to 48"H may be outfitted with a Titan Cart. The Titan Cart is a solid steel welded frame with ball-bearing wheels for safe mobility. See page 177.

FINISH - See page 5 for finish specifications.

Visit our website at www.russwood.net

Wood Shelving Basics

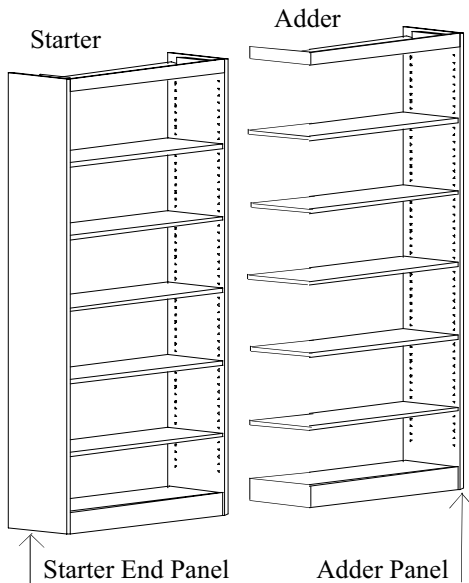

Starters consist of two starter end panels 1" thick, 35"W top and bottom frame assemblies, one base shelf and adjustable shelves. The overall width of starter units is 37"W. *Starters can be used as individual units or in combination with adder units.*

Adders consist of one adder end panel 1" thick, 35"W top and bottom frame assemblies one base shelf and adjustable shelves. The overall width of starter units is 36"W. *Adder unit(s) must be used in conjunction with a starter unit.*

For each run of shelving - one starter unit and the appropriate number of adders should be ordered.

Our top quality solid red oak shelf vs. those that aren't.

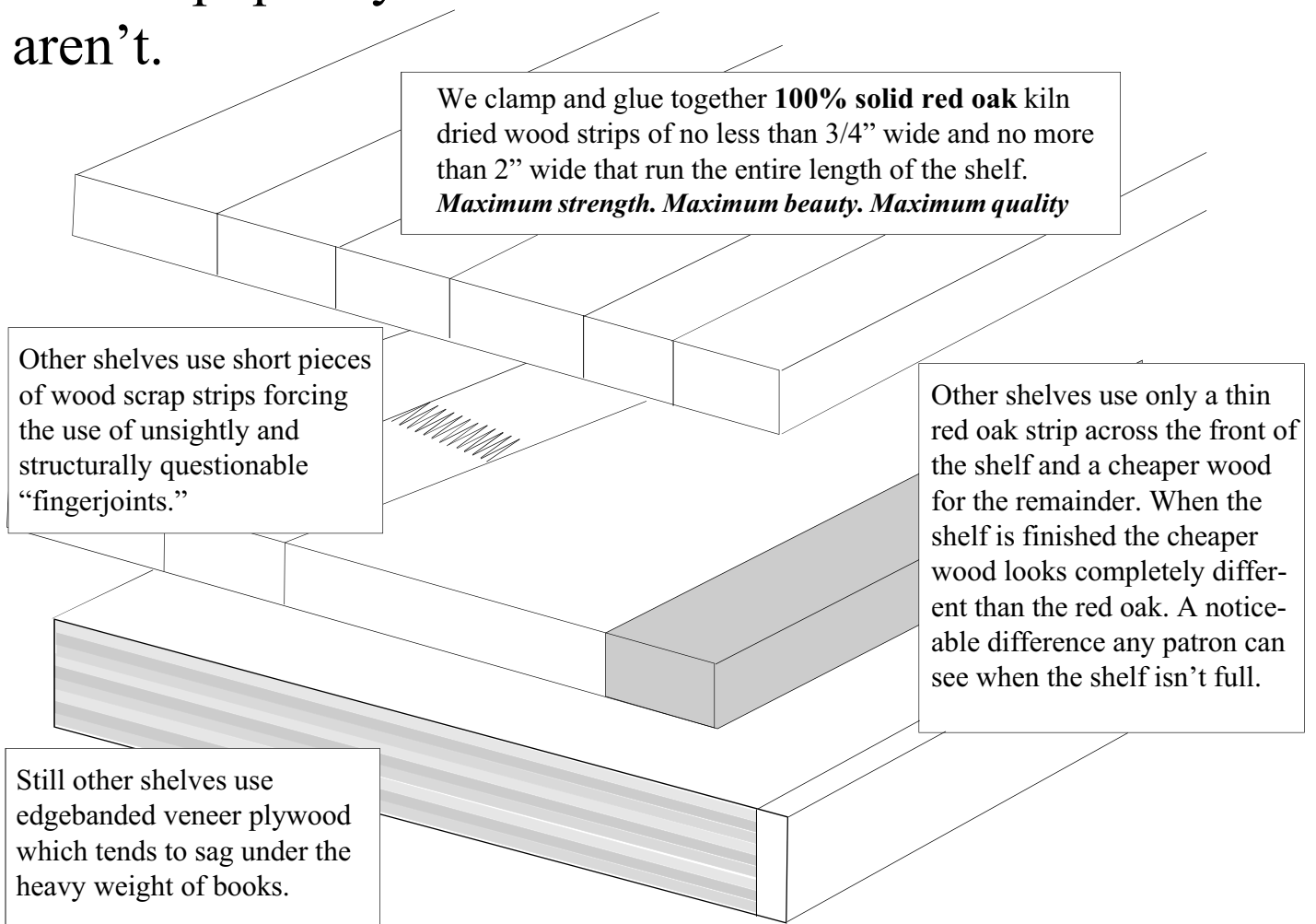



Shelving With Bullnose Edges

All shelving can be constructed with the stylish bullnose edges on uprights and shelving edges. All shelving with this option will be quoted on a per order basis. Listed shelving dimensions and catalog numbers can be used for general planning and quote requests.

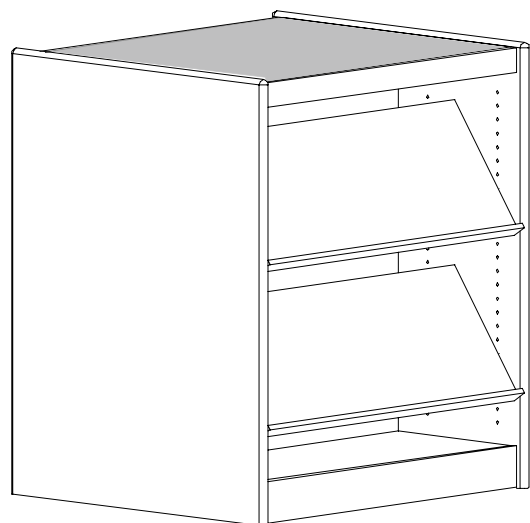

Shown as 42" Double-face Periodical Shelf

Shelving W/ Individual Laminate Top (ILT)

All shelving 60" or less can have an individual laminate top (ILT) of your choice. This option is an additional charge to standard shelving prices. See price list for more information. **To order (ILT) shelving:** (1) choose the shelf unit (2) choose the laminate color (3) add the (ILT) upcharge to price listed. (4) Add the (ILT) suffix to the shelf unit catalog # on your order *specifying laminate color.*

Add (ILT) suffix here ↓

(Catalog # 2FPBS-4212)

(2FPBS-4212-ILT) *i.e. double-face 42" fixed picture book shelf unit with 12"D shelves with a grey ILT*

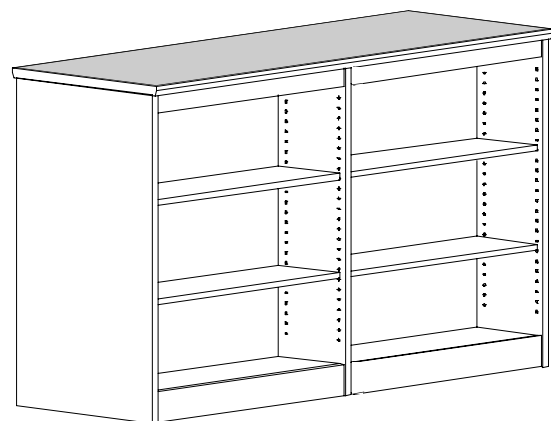

Shown as 48" Double-face - 1 Starter/1 Adder

Shelving With Continuous Laminate Top

All shelving 60" or less is also available in the continuous top construction. Continuous tops are offered in 1-1/4" and 3/4" thicknesses and constructed with the laminate of your choice. Top sections will be constructed in the longest, most practical lengths, sections will be fastened with wood biscuits and tight joint bolts to maximize top continuity.

All continuous top shelving will be quoted on a per order basis. Top thickness, laminate choice and edgeband choice must be included in quote request. **See next pages for edge details.**

Determining Overall Height of Units with Continous Tops				
Top Thickness	60"H unit	48"H unit	42"H unit	36"H unit
1-1/4"	61"	49"	43-1/4"	37"
3/4"	60-1/2"	48-1/2"	42-3/4"	36-1/2"

Planning For & Ordering An Edge Detail For Continuous Top Shelving

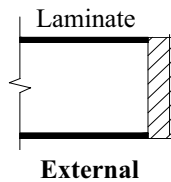
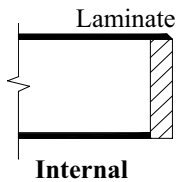

When choosing an edgeband for continuous tops you can either have the edgeband placed internally (the edgeband captured by the laminate) or externally (the laminate captured by the edge band)

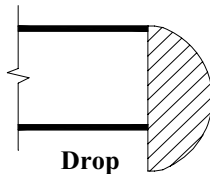
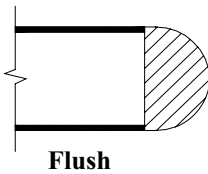

When choosing an edgeband for continuous tops you can either have the edgeband placed flush with the bottom of the top or dropped below the bottom.

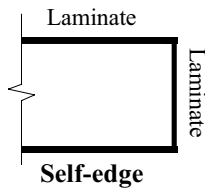

When choosing an edgeband for continuous tops you can have a laminate edgeband matching the laminate top (self-edge). All edges and corners are finished for maximum “bump” protection.

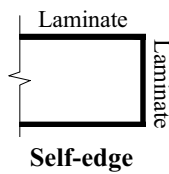
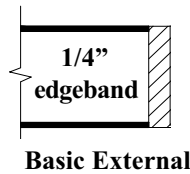
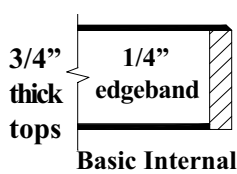

3/4" thick continuous tops are only offered with a BASIC 1/4" T solid wood internal or eternal edgeband or the matching laminate (self-edge.)

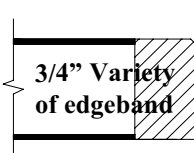
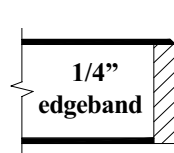
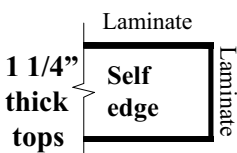

1-1/4" thick continuous tops can be constructed with a laminated self edge OR 1/4" T Internal BASIC solid wood edgeband OR 3/4" T solid wood with a variety of internal or external edgeband details.

Add suffix here ↓
(Catalog # 2SS-6024 CT07)
(2SS-6024 **CT07**) i.e. double-face 60" shelf unit with a continuous top with a flush shallow bullnose internal edgeband)

Important planning and ordering note: When ordering the continuous top option you must include one of the appropriate edgeband suffixes* on the following page with the shelving catalog # to indicate the options that you desire.

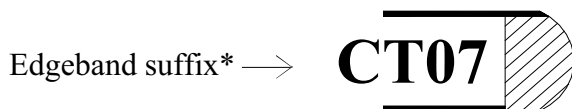

Important planning and ordering note: The edgeband suffix* you choose also determines the thickness of the top and whether the edgeband is flush or drop and placed internally or externally.

Edgeband suffixes and details on following page.

Edgeband Suffixes and Details for Continuous Tops

See the previous two pages for important planning and ordering information of continuous top shelving.

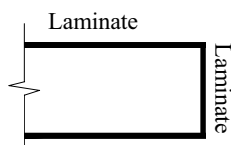

Self Edge
3/4" thick top - CT01
1-1/4" thick top - CT04

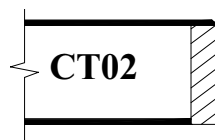

3/4" thick top (Internal)
Basic Flush

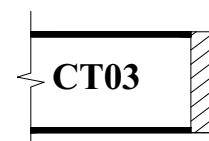

3/4" thick top (External)
Basic Flush External



1 1/4" thick top (Internal)
Basic Flush

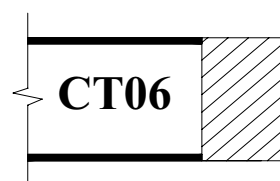

1 1/4" thick top (External)
Montana Flush

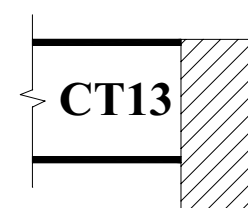

1 1/4" thick top (External)
Montana Drop

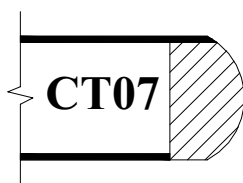

1 1/4" thick top (Internal)
Shallow Bullnose Flush

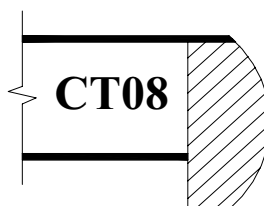

1 1/4" thick top (Internal)
Shallow Bullnose Drop

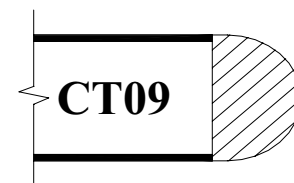

1 1/4" thick top (External)
Bullnose Flush

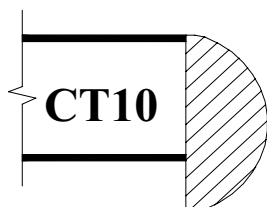

1 1/4" thick top (External)
Bullnose Drop

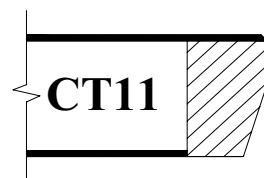

1 1/4" thick top (Internal)
Premier Flush

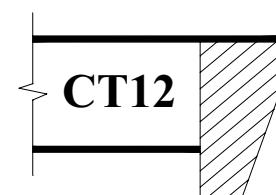

1 1/4" thick top (Internal)
Premier Drop

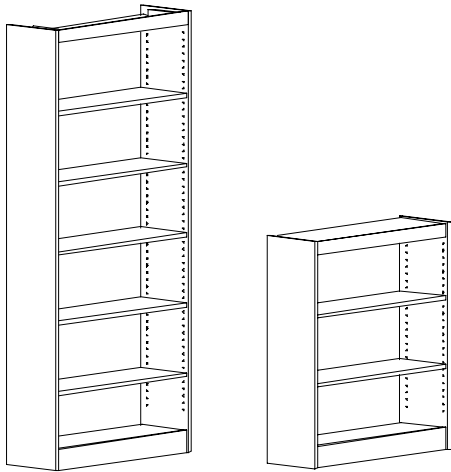

Shown 82" and 42"

Standard Single-Faced Shelving

See previous section "Shelving Basics" for important planning and ordering information for Individual Laminate Top Shelving and Continuous Top Shelving options.

ILT upcharge: Single-face top frames \$49.00 per unit.

Bullnose upcharge: 5% of Shelving List Prices

***NC State Contract orders of 60"H - 72"H - 82"H shelf units will receive 1 additional shelf per unit.**

Catalog #	Description	# Adj. Shelves	Unit Depth	Unit Width	Price
<i>Prices do not include backs - see page 176 for details and pricing on backs.</i>					
1SS-8210	82"H Starter Veneer Top	5*	10"	37"	
1SA-8210	82"H Adder Veneer Top	5*	10"	36"	
1SS-8212	82"H Starter Veneer Top	5*	12"	37"	
1SA-8212	82"H Adder Veneer Top	5*	12"	36"	
1SS-7210	72"H Starter Veneer Top	4*	10"	37"	
1SA-7210	72"H Adder Veneer Top	4*	10"	36"	
1SS-7212	72"H Starter Veneer Top	4*	12"	37"	
1SA-7212	72"H Adder Veneer Top	4*	12"	36"	
1SS-6010	60"H Starter Veneer Top	3*	10"	37"	
1SA-6010	60"H Adder Veneer Top	3*	10"	36"	
1SS-6012	60"H Starter Veneer Top	3*	12"	37"	
1SA-6012	60"H Adder Veneer Top	3*	12"	36"	
1SS-4810	48" H Starter Veneer Top	2	10"	37"	
1SA-4810	48"H Adder Veneer Top	2	10"	36"	
1SS-4812	48"H Starter Veneer Top	2	12"	37"	
1SA-4812	48"H Adder Veneer Top	2	12"	36"	
1SS-4210	42"H Starter Veneer Top	2	10"	37"	
1SA-4210	42"H Adder Veneer Top	2	10"	36"	
1SS-4212	42"H Starter Veneer Top	2	12"	37"	
1SA-4212	42"H Adder Veneer Top	2	12"	36"	
1SS-3610	36"H Starter Veneer Top	1	10"	37"	
1SA-3610	36"H Adder Veneer Top	1	10"	36"	
1SS-3612	36"H Starter Veneer Top	1	12"	37"	
1SA-3612	36"H Adder Veneer Top	1	12"	36"	

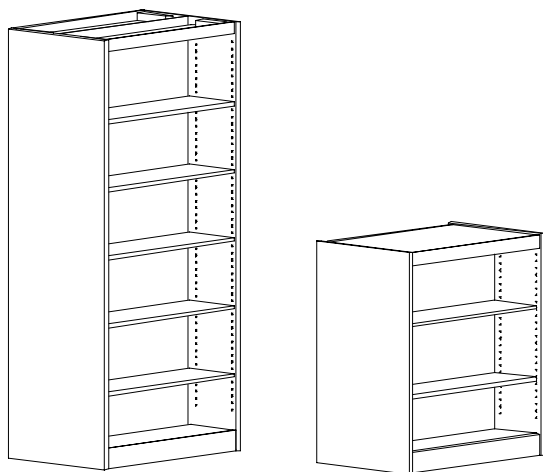

Shown 82” and 42”

Standard Double-Faced Shelving

See previous section “Wood Shelving Basics” for important planning and ordering information for Individual Laminate Top Shelving and Continuous Top Shelving options.

ILT upcharge: Double-face top frames \$105 per unit.

Bullnose upcharge: 5% of Shelving List Prices

Mobile Shelving: See the page 177 for details on the TITON Cart for Double-Faced shelving which allows you to safely roll any single section of 36” to 48” shelving where you need it.

***NC State Contract orders of 60”H - 72”H - 82”H shelf units will receive 2 additional shelves per unit.**

Catalog #	Description	# Adj. Shelves	Unit Depth	Unit Width	Price
<i>Prices do not include partitions - see page 176 for details and pricing on partitions.</i>					
2SS-8220	82”H Starter Veneer Top	10*	19 3/4”	37”	
2SA-8220	82”H Adder Veneer Top	10*	19 3/4”	36”	
2SS-8224	82”H Starter Veneer Top	10*	23 3/4”	37”	
2SA-8224	82”H Adder Veneer Top	10*	23 3/4”	36”	
2SS-7220	72”H Starter Veneer Top	8*	19 3/4”	37”	
2SA-7220	72”H Adder Veneer Top	8*	19 3/4”	36”	
2SS-7224	72”H Starter Veneer Top	8*	23 3/4”	37”	
2SA-7224	72”H Adder Veneer Top	8*	23 3/4”	36”	
2SS-6020	60”H Starter Veneer Top	6*	19 3/4”	37”	
2SA-6020	60”H Adder Veneer Top	6*	19 3/4”	36”	
2SS-6024	60”H Starter Veneer Top	6*	23 3/4”	37”	
2SA-6024	60”H Adder Veneer Top	6*	23 3/4”	36”	
2SS-4820	48” H Starter Veneer Top	4	19 3/4”	37”	
2SA-4820	48”H Adder Veneer Top	4	19 3/4”	36”	
2SS-4824	48”H Starter Veneer Top	4	23 3/4”	37”	
2SA-4824	48”H Adder Veneer Top	4	23 3/4”	36”	
2SS-4220	42”H Starter Veneer Top	4	19 3/4”	37”	
2SA-4220	42”H Adder Veneer Top	4	19 3/4”	36”	
2SS-4224	42”H Starter Veneer Top	4	23 3/4”	37”	
2SA-4224	42”H Adder Veneer Top	4	23 3/4”	36”	
2SS-3620	36”H Starter Veneer Top	2	19 3/4”	37”	
2SA-3620	36”H Adder Veneer Top	2	19 3/4”	36”	
2SS-3624	36”H Starter Veneer Top	2	23 3/4”	37”	
2SA-3624	36”H Adder Veneer Top	2	23 3/4”	36”	

SEE PAGE 177 FOR INFORMATION ON MAKING DOUBLE-FACE SHELVING MOBILE

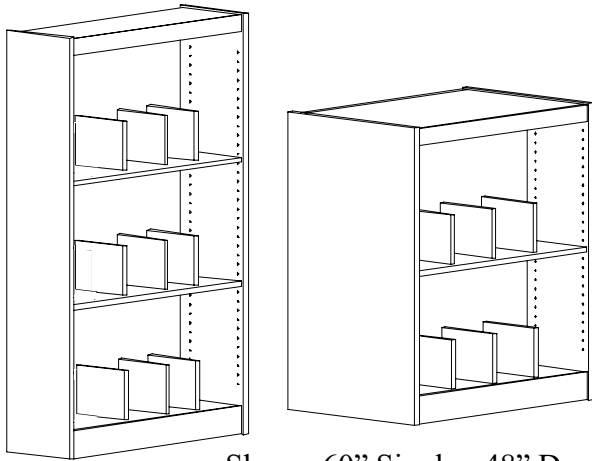

Shown 60" Single - 48" Double

Fixed-Divider Picture Book Shelving

See previous section "Shelving Basics" for important planning & ordering information for Individual Laminate Top Shelving and Continuous Top Shelving options.

ILT upcharge: Single-face top frames \$49.00 per unit.
Double-face top frames \$105 per unit.

Bullnose upcharge: 5% of Shelving List Prices

Each shelf will have 3 fixed dividers fastened equidistant along shelf length.

Mobile Shelving: See the page 177 for details on the TITON Cart for Double-Faced shelving which allows you to safely roll any single section of 36"H to 48"H shelving where you need it.

Catalog #	Description	# Shelves	Unit Depth	Unit Width	Price
<i>Prices do not include backs or partitions - see page 176 for details and pricing on backs and partitions.</i>					
1FPBS-6012	60"H Single Starter Veneer Top	2 Adj. - 1 Fixed	12"	37"	
1FPBA-6012	60"H Single Adder Veneer Top	2 Adj. - 1 Fixed	12"	36"	
2FPBS-6024	60"H Double Starter Veneer Top	4 Adj. - 2 Fixed	23-3/4"	37"	
2FPBA-6024	60"H Double Adder Veneer Top	4 Adj. - 2 Fixed	23-3/4"	36"	
1FPBS-4812	48"H Single Starter Veneer Top	1 Adj. - 1 Fixed	12"	37"	
1FPBA-4812	48"H Single Adder Veneer Top	1 Adj. - 1 Fixed	12"	36"	
2FPBS-4824	48"H Double Starter Veneer Top	1 Adj. - 1 Fixed	23-3/4"	37"	
2FPBA-4824	48"H Double Adder Veneer Top	1 Adj. - 1 Fixed	23-3/4"	36"	
1FPBS-4212	42"H Single Starter Veneer Top	1 Adj. - 1 Fixed	12"	37"	
1FPBA-4212	42"H Single Adder Veneer Top	1 Adj. - 1 Fixed	12"	36"	
2FPBS-4224	42"H Double Starter Veneer Top	1 Adj. - 1 Fixed	23-3/4"	37"	
2FPBA-4224	42"H Double Adder Veneer Top	1 Adj. - 1 Fixed	23-3/4"	36"	
1FPBS-3612	36"H Single Starter Veneer Top	1 Adj. - 1 Fixed	12"	37"	
1FPBA-3612	36"H Single Adder Veneer Top	1 Adj. - 1 Fixed	12"	36"	
2FPBS-3624	36"H Double Starter Veneer Top	1 Adj. - 1 Fixed	23-3/4"	37"	
2FPBA-3624	36"H Double Adder Veneer Top	1 Adj. - 1 Fixed	23-3/4"	36"	

"THE SIGNIFICANT PROBLEMS WE FACE CANNOT BE SOLVED AT THE

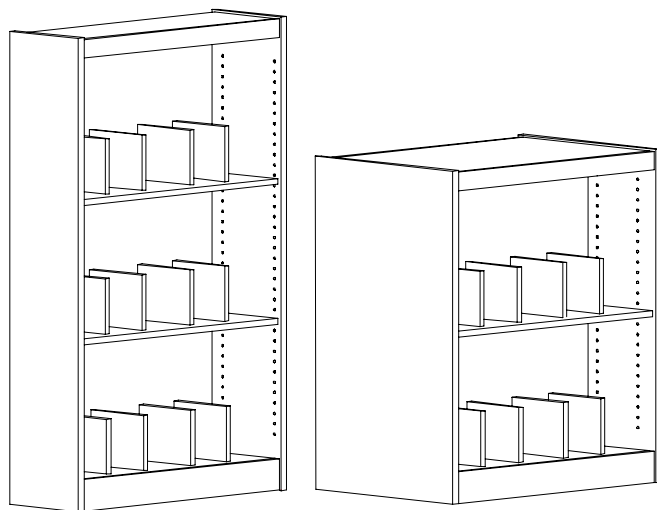

Shown 60" Single - 48" Double

Adjustable Divider Picture Book Shelving

See previous section "Shelving Basics" for important planning & ordering information for Individual Laminate Top Shelving and Continuous Top Shelving options.

ILT upcharge: Single-face top frames \$49.00 per unit.
Double-face top frames \$105 per unit.

Bullnose upcharge: 5% of Shelving List Prices

Each shelf will have 3 dividers that adjust on 1/2" centers along shelf length.

Mobile Shelving: See the last page of this section for details on the TITON Cart for Double-Faced shelving which allows you to safely roll any single section of 36"H to 48"H shelving where you need it.

Catalog #	Description	# Shelves	Unit Depth	Unit Width	Price
<i>Prices do not include backs or partitions - see page 176 for details and pricing on backs and partitions.</i>					
1APBS-6012	60"H Single Starter Veneer Top	2 Adj. - 1 Fixed	12"	37"	
1APBA-6012	60"H Single Adder Veneer Top	2 Adj. - 1 Fixed	12"	36"	
2APBS-6024	60"H Double Starter Veneer Top	4 Adj. - 2 Fixed	23-3/4"	37"	
2APBA-6024	60"H Double Adder Veneer Top	4 Adj. - 2 Fixed	23-3/4"	36"	
1APBS-4812	48"H Single Starter Veneer Top	1 Adj. - 1 Fixed	12"	37"	
1APBA-4812	48"H Single Adder Veneer Top	1 Adj. - 1 Fixed	12"	36"	
2APBS-4824	48"H Double Starter Veneer Top	1 Adj. - 1 Fixed	23-3/4"	37"	
2APBA-4824	48"H Double Adder Veneer Top	1 Adj. - 1 Fixed	23-3/4"	36"	
1APBS-4212	42"H Single Starter Veneer Top	1 Adj. - 1 Fixed	12"	37"	
1APBA-4212	42"H Single Adder Veneer Top	1 Adj. - 1 Fixed	12"	36"	
2APBS-4224	42"H Double Starter Veneer Top	1 Adj. - 1 Fixed	23-3/4"	37"	
2APBA-4224	42"H Double Adder Veneer Top	1 Adj. - 1 Fixed	23-3/4"	36"	
1APBS-3612	36"H Single Starter Veneer Top	1 Adj. - 1 Fixed	12"	37"	
1APBA-3612	36"H Single Adder Veneer Top	1 Adj. - 1 Fixed	12"	36"	
2APBS-3624	36"H Double Starter Veneer Top	1 Adj. - 1 Fixed	23-3/4"	37"	
2APBA-3624	36"H Double Adder Veneer Top	1 Adj. - 1 Fixed	23-3/4"	36"	

SAME LEVEL OF THINKING WE WERE AT WHEN WE CREATED THEM."

ALBERT EINSTEIN (1879-1955)

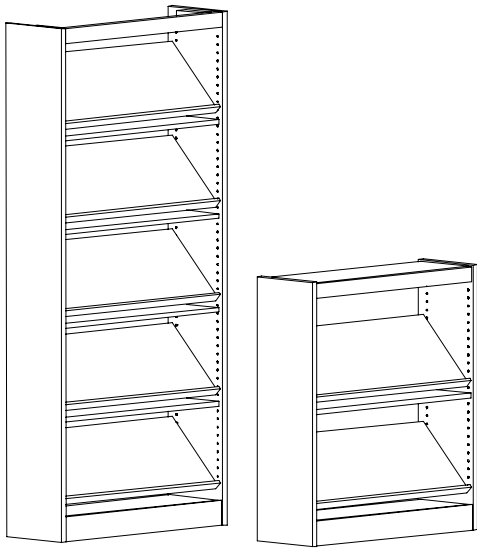

Shown 82" and 42" Single

Periodical Shelving

See previous section "Shelving Basics" for important planning & ordering information for Individual Laminate Top Shelving and Continuous Top Shelving options.

ILT upcharge: Single-face top frames \$49.00 per unit.
Double-face top frames \$105 per unit.

Bullnose upcharge: 5% of Shelving List Prices

Each shelf will tilt up to allow for back-issue storage underneath on a solid wood shelf.

NOTE: Prices do not include backs or partitions. See the last page of this section for prices for backs and partitions.

Catalog #	Description	# Shelves	Depth"	Width"	Price
<i>Prices do not include backs or partitions - see page 176 for details and pricing on backs and partitions.</i>					
1PDS-8212	82"H Single Starter Veneer Top	5 Mag - 4 Adj - 1 Fixed	12"	37"	
1PDA-8212	82"H Single Adder Veneer Top	5 Mag - 4 Adj - 1 Fixed	12"	36"	
2PDS-8224	82"H Double Starter Veneer Top	10 Mag - 8 Adj - 2 Fixed	23-3/4"	37"	
2PDA-8224	82"H Double Adder Veneer Top	10 Mag - 8 Adj - 2 Fixed	23-3/4"	36"	
1PDS-7212	72"H Single Starter Veneer Top	4 Mag - 3 Adj - 1 Fixed	12"	37"	
1PDA-7212	72"H Single Adder Veneer Top	4 Mag - 3 Adj - 1 Fixed	12"	36"	
2PDS-7224	72"H Double Starter Veneer Top	8 Mag - 6 Adj - 2 Fixed	23-3/4"	37"	
2PDA-7224	72"H Double Adder Veneer Top	8 Mag - 6 Adj - 2 Fixed	23-3/4"	36"	
1PDS-6012	60"H Single Starter Veneer Top	3 Mag - 2 Adj - 1 Fixed	12"	37"	
1PDA-6012	60"H Single Adder Veneer Top	3 Mag - 2 Adj - 1 Fixed	12"	36"	
2PDS-6024	60"H Double Starter Veneer Top	6 Mag - 4 Adj - 2 Fixed	23-3/4"	37"	
2PDA-6024	60"H Double Adder Veneer Top	6 Mag - 4 Adj - 2 Fixed	23-3/4"	36"	
1PDS-4812	48"H Single Starter Veneer Top	2 Mag - 1 Adj - 1 Fixed	12"	37"	
1PDA-4812	48"H Single Adder Veneer Top	2 Mag - 1 Adj - 1 Fixed	12"	36"	
2PDS-4824	48"H Double Starter Veneer Top	4 Mag - 2 Adj - 2 Fixed	23-3/4"	37"	
2PDA-4824	48"H Double Adder Veneer Top	4 Mag - 2 Adj - 2 Fixed	23-3/4"	36"	
1PDS-4212	42"H Single Starter Veneer Top	2 Mag - 1 Adj - 1 Fixed	12"	37"	
1PDA-4212	42"H Single Adder Veneer Top	2 Mag - 1 Adj - 1 Fixed	12"	36"	
2PDS-4224	42"H Double Starter Veneer Top	4 Mag - 2 Adj - 2 Fixed	23-3/4"	37"	
2PDA-4224	42"H Double Adder Veneer Top	4 Mag - 2 Adj - 2 Fixed	23-3/4"	36"	
1PDS-3612	36"H Single Starter Veneer Top	1 Mag - 1 Fixed	12"	37"	
1PDA-3612	36"H Single Adder Veneer Top	1 Mag - 1 Fixed	12"	36"	
2PDS-3624	36"H Double Starter Veneer Top	2 Mag - 2 Fixed	23-3/4"	37"	
2PDA-3624	36"H Double Adder Veneer Top	2 Mag - 2 Fixed	23-3/4"	36"	

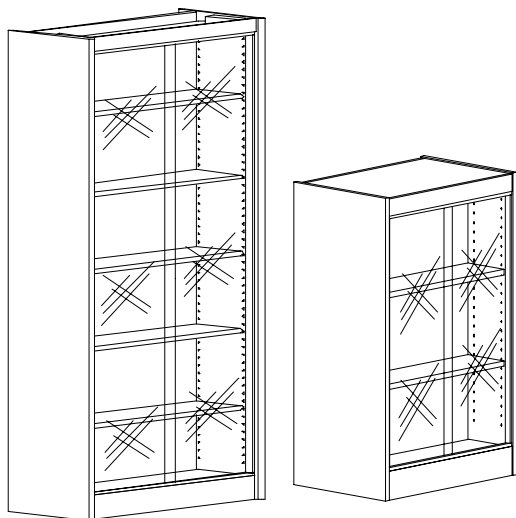

Shown 82" and 48" Single

Glass Door Shelving

See introduction of this section "Shelving Basics" for important planning & ordering information for Individual Laminate Top Shelving and Continuous Top Shelving options.

ILT upcharge: Single-face top frames \$49.00 per unit.
Double-face top frames \$105 per unit.

Bullnose upcharge: 5% of Shelving List Prices

Each shelf unit will have sliding glass doors, fastened back, 10"D adjustable shelves and key-lock.

NOTE: Prices do not include backs or partitions. See the last page of this section for prices for backs and partitions.

Catalog #	Description	# Shelves	Unit Depth	Unit Width	Price
<i>Prices do not include backs or partitions - see page 176 for details and pricing on backs and partitions.</i>					
1GS-8212	82"H Single Starter Veneer Top	5 Adj - 1 Fixed	12"	37"	
1GA-8212	82"H Single Adder Veneer Top	5 Adj - 1 Fixed	12"	36"	
1GS-7212	72"H Single Starter Veneer Top	4 Adj - 1 Fixed	12"	37"	
1GA-7212	72"H Single Adder Veneer Top	4 Adj - 1 Fixed	12"	36"	
1GS-6012	60"H Single Starter Veneer Top	3 Adj - 1 Fixed	12"	37"	
1GA-6012	60"H Single Adder Veneer Top	3 Adj - 1 Fixed	12"	36"	
1GS-4812	48"H Single Starter Veneer Top	2 Adj -1 Fixed	12"	37"	
1GA-4812	48"H Single Adder Veneer Top	2 Adj -1 Fixed	12"	36"	
1GS-4212	42"H Single Starter Veneer Top	2 Adj -1 Fixed	12"	37"	
1GA-4212	42"H Single Adder Veneer Top	2 Adj -1 Fixed	12"	36"	

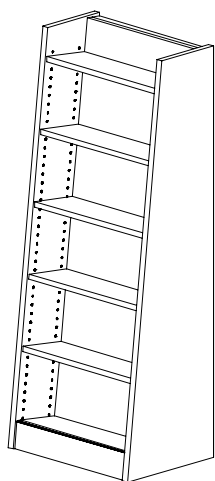

Shown 72"

End of Range Shelf

This unit is 23-3/4"W so as to fit at the end of a run of double faced shelves. Base is 17"D and tapers up for stability. Shelves are 8"D. 72"H unit has 5 adjustable shelves. 60"H unit has 4 adjustable shelves. 42"H unit has 3 adjustable shelves. All heights have a fixed bottom shelf, an open top and include a 1/4"T red oak veneer plywood back.

Catalog #	Description	Height"	Width"	Depth"	Price
1SER-722375	72"H End of Range Shelf	72	23-3/4	17	
1SER-602375	60"H End of Range Shelf	60	23-3/4	17	
1SER-422375	42"H End of Range Shelf	42	23-3/4	17	

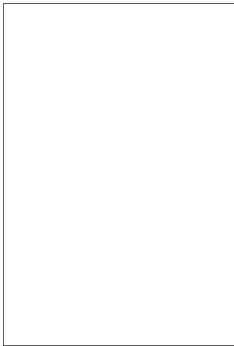

Single-Faced Shelving Back Panel

Backs will be "captured" into a continuous rabbet slot on tops, intermediates and end panels and screw-attached to top and bottom to provide greater stability. All backs will be have a matching finish on the interior side of the panel.

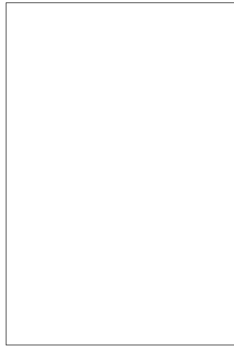

Double-Faced Shelving Partition

Partitions will be "captured" into a continuous dado slot on tops, intermediates and end panels and screw-attached to top and bottom to provide greater stability. All backs will be have a matching finish on the interior and exterior sides of the panel.

Catalog #	Description	Price
OVB-82	81"H x 35-11/16" x 1/4" Back Panel	
OVB-72	71"H x 35-11/16" x 1/4" Back Panel	
OVB-60	59"H x 35-11/16" x 1/4" Back Panel	
OVB-48	47"H x 35-11/16" x 1/4" Back Panel	
OVB-42	41"H x 35-11/16" x 1/4" Back Panel	
OVB-36	35"H x 35-11/16" x 1/4" Back Panel	

Catalog #	Description	Price
OVP-82	81"H x 35-11/16" x 1/4" Partition	
OVP-72	71"H x 35-11/16" x 1/4" Partition	
OVP-60	59"H x 35-11/16" x 1/4" Partition	
OVP-48	47"H x 35-11/16" x 1/4" Partition	
OVP-42	41"H x 35-11/16" x 1/4" Partition	
OVP-36	35"H x 35-11/16" x 1/4" Partition	

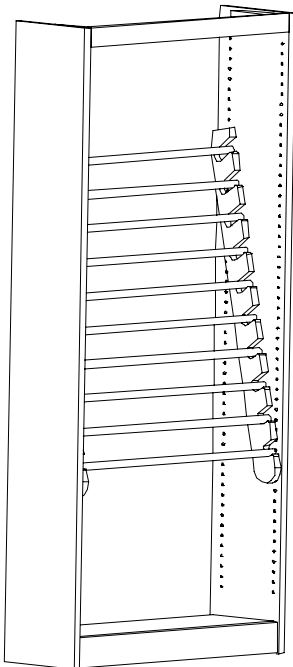

Shelf unit not included.

Newspaper Rod Insert will fit into 10" or 12" deep single-faced shelving, 82", 72" or 60" high. File insert will be made of two hardwood cleats, 1-1/4" thick with 1" notched slots for rods. Cleats will be attached to uprights with wood screws.

Insert only is included in pricing.

Catalog #	Description	Insert Height	Rod Length	Cleat Thickness	Price
INS-8260	Newspaper Rod Insert for 82"H Shelf (Holds 10 rods)	45-1/2"	34-7/16	1-1/4"	
INS-6042	Newspaper Rod Insert for 72"H Shelf (Holds 8 rods)	37"	34-7/16	1-1/4"	
INS-4236	Newspaper Rod Insert for 60"H Shelf (Holds 6 rods)	29-1/8"	34-7/16	1-1/4"	

**One Electrical Outlet Cutout
12” Bottom Frame**

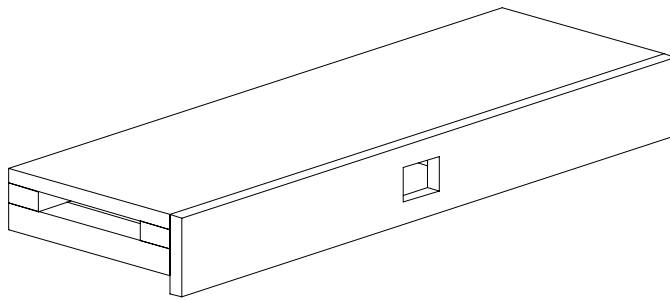

This accessory *replaces* a standard bottom frame and can be used in any of the 12” shelving and provides a cutout for one outlet in the middle of the toe board. Frame can be used with either a Starter or Adder Shelf.

Catalog #	Description	Height	Width	Depth	Price
A-34	One Electrical Outlet Cutout for 12" Bottom Frame	4"	35"	11-1/2"	

**Two Electrical Outlet Cutout
12” Bottom Frame**

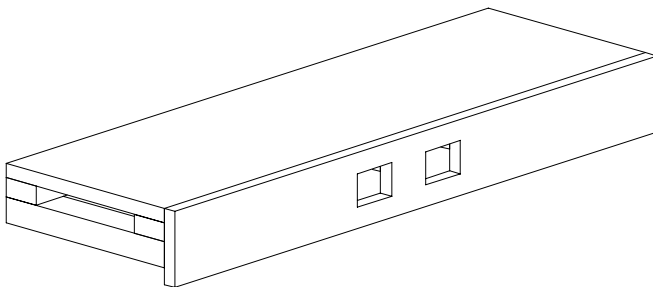

This accessory *replaces* a standard bottom frame that can be used in any of the 12” shelving and provides cutouts for two outlets in the middle of the toe board. Frame can be used with either a Starter or Adder Shelf.

Catalog #	Description	Height	Width	Depth	Price
A-35	Two Electrical Outlet Cutout for 12" Bottom Frame	4"	35"	11-1/2"	



Titan Cart (for standard 12” double-faced shelving)

This accessory *replaces* a standard bottom frame and is available for use with any 36”, 42” or 48” double-faced shelving. Vertical uprights fasten to the cart in the same manner as the solid wood bottom frame. All steel construction with 4 caster swivel wheels can easily hold 400 lbs. of book and shelf weight. A solid red oak kick plate is finished to match shelving and fastened to the steel frame.

ADD TITAN CART PRICING TO INDIVIDUAL SHELF PRICE

Catalog #	Description	Height	Width	Depth	Price
A-36	Titon Cart	5"	35"	23-1/2"	

MAKE DOUBLE FACE SHELVING UP TO 48”H - MOBILE - BY SIMPLY ADDING THE TITAN CART.

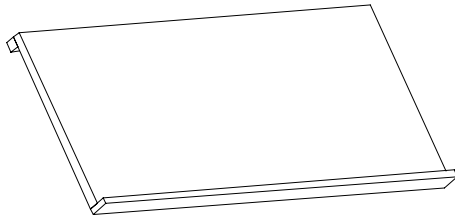

Periodical Shelf

This shelf may be used in conjunction with any standard shelf unit. For back issue storage a flat shelf may also be ordered. Shelf is 3/4" T red oak veneer core plywood with a 1/2" T x 1-1/2" W solid red oak ledger.

Catalog #	Description	Height	Width	Depth	Price
A-42	One Periodical Shelf - flat shelf not included		34-15-16"	13-29/32"	

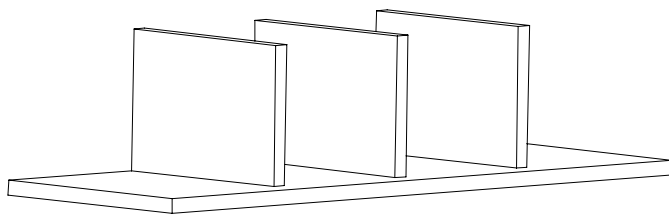

Fixed Picture Book Shelf

This shelf may be used in conjunction with any standard shelf unit. The shelf and dividers will be kiln-dried solid red oak (no mixed wood) glued up in strips of no less than 3/4" W and no more than 2" W, and free from structural defects. Dividers are fastened to shelf with 1-1/2" wood screws. The bottom shelf is 3/4" T red oak veneer core plywood with same solid wood dividers.

Catalog #	Description	Height	Width	Depth	Price
A-43	One Fixed Picture Book Shelf (divider 3/4" T)	7-3/4"	11-1/2"	34-15-16"	
A-43B	One Fixed Picture Book BASE Shelf (divider 3/4" T)	7-3/4"	10-3/4"	34-15-16"	

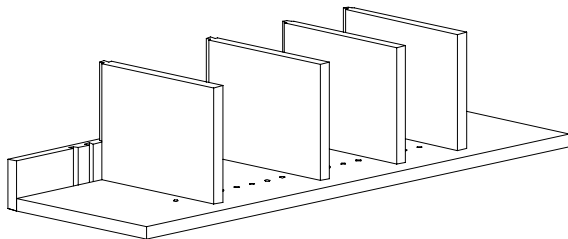

Adjustable Picture Book Shelf

This shelf may be used in conjunction with any standard shelf unit. Both adjustable and base shelf, dividers and adjustment strip will be kiln-dried solid red oak (no mixed wood) glued up in strips of no less than 3/4" W and no more than 2" W, and free from structural defects. The bottom shelf is 3/4" T red oak veneer core plywood with same solid wood dividers.

Catalog #	Description	Height	Width	Depth	Price
A-44	One Adjustable Picture Book Shelf (divider 3/4" T)	7-3/4"	11-1/2"	34-15-16"	
A-44B	One Adjustable Picture Book BASE Shelf (divider 3/4" T)	7-3/4"	10-3/4"	34-15-16"	

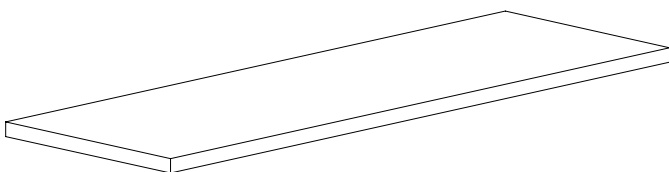

Standard Flat Shelf

This shelf may be used in conjunction with any standard shelf unit. The shelf and dividers will be kiln-dried solid red oak (no mixed wood) glued up in strips of no less than 3/4" W and no more than 2" W, and free from structural defects.

Catalog #	Description	Thickness	Width	Depth	Price
A-45	One Adjustable Flat Shelf for 12" D unit	3/4"	11-1/2"	34-15/16"	
A-45B	One Flat BASE Shelf for 12" D unit	3/4"	11-1/2"	34-15/16"	
A-46	One Adjustable Flat Shelf for 10" D unit	3/4"	9-1/2"	34-15/16"	
A-46B	One Flat BASE Shelf for 10" D unit	3/4"	9-1/2"	34-15/16"	